

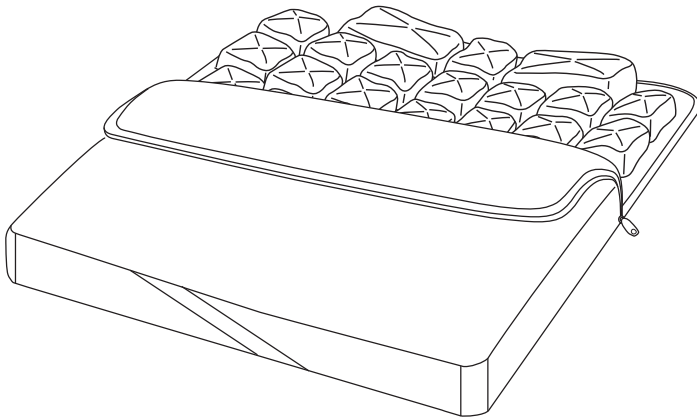

ROHO® HARMONY® Overlay Cushion

Operation Manual



Supplier: This manual must be given to the user of this product.

Operator (Individual or Caregiver): Before using this product, read the instructions and save for future reference.

Table of Contents

Intended Use	2
Warnings and Cautions	2-3
Parts Detail	3
Product Specifications	3
Cushion Adjustment	4
Cover Removal and Replacement	5
Troubleshooting, Disposal and Limited Warranty	5
Cleaning and Disinfecting	6



Manufactured by ROHO, Inc.

100 N. Florida Ave., Belleville, IL 62221-5429 U.S.A.

U.S.A.: 800-851-3449 • Fax: 888-551-3449 • Customer Care: cc@roho.com

Outside the U.S.A.: 618-277-9150 • Fax: 618-277-6518 • intl@roho.com

ROHO.com

© 2011, 2015 ROHO, Inc.

The following are trademarks and registered trademarks of ROHO, Inc.: ROHO®, shape fitting technology® and HARMONY®.

Products in this manual may be covered by one or more U.S. and foreign patents. For further details, please refer to ROHO.com.

ROHO, Inc. has a policy of continual product improvement and reserves the right to amend this document. A current version of this document is available at ROHO.com.

Intended Use

The ROHO® HARMONY® Overlay Cushion (HARMONY Overlay) is an adjustable, air-filled, segmented-design, multi-purpose seating support surface intended to conform to an individual's seated shape to provide skin/soft tissue protection on a cushioned surface (contoured or planar), including wheelchairs with captain's seats, geriatric chairs, office chairs, motor vehicle seats, or airplane seats. There is a weight limit of 275 lbs. (125 kg), and the cushion must be properly sized to the individual.

ROHO, Inc. recommends evaluation by a clinician who is experienced in seating, positioning and mobility to determine whether the cushion is appropriate for the individual.

ROHO medical products are intended to be part of an overall care regimen. ROHO, Inc. recommends that a clinician make product recommendations based upon an evaluation of the individual's medical and therapeutic needs and overall condition.



Warnings

- **Skin/soft tissue breakdown can occur due to a number of factors, which vary by individual. Check skin frequently, at least once a day. Redness, bruising, or darker areas (when compared to normal skin) may indicate the beginning of soft tissue breakdown and may need to be addressed. If there is any discoloration to skin/soft tissue, STOP USE immediately. If the discoloration does not disappear within 30 minutes after disuse, immediately consult a healthcare professional.**
- **The cushion and the cover MUST be compatible sizes and MUST be used as directed in this manual. IF THEY ARE NOT: 1) The benefits provided by the cushion may be reduced or eliminated, increasing the risk to skin or to other soft tissue, and 2) the individual may become unstable and vulnerable to falling.**
- **DO NOT use your cushion on top of, or in conjunction with, any other products or materials, except as indicated in this manual. Doing so may cause the individual to become unstable and vulnerable to falling.**
- **DO NOT use this cushion as a water flotation device (e.g. a Life Preserver). It will NOT support you in water.**
- **If you are unable to perform any tasks described in this manual, seek assistance.**



Cautions

- **DO NOT use a pump, cover or a repair kit other than those provided by ROHO, Inc. Doing so may void your product's warranty.**
- **DO NOT modify the cushion or any components. Doing so may result in damage to the product and will void the warranty.**
- **Changes in altitude may require adjustment to your cushion.**
- **Keep the cushion away from sharp objects.**

Cautions

- DO NOT expose the product to high heat, open flames, or hot ashes.
- If the cushion has been in temperatures lower than 32° F (0° C) and exhibits unusual stiffness, allow the cushion to warm to room temperature.
- DO NOT use the inflation valve as a handle for carrying or pulling the cushion. Carry the cushion by the the cushion base or by the carrying handle on the cover.

Parts Detail

Package Contents:

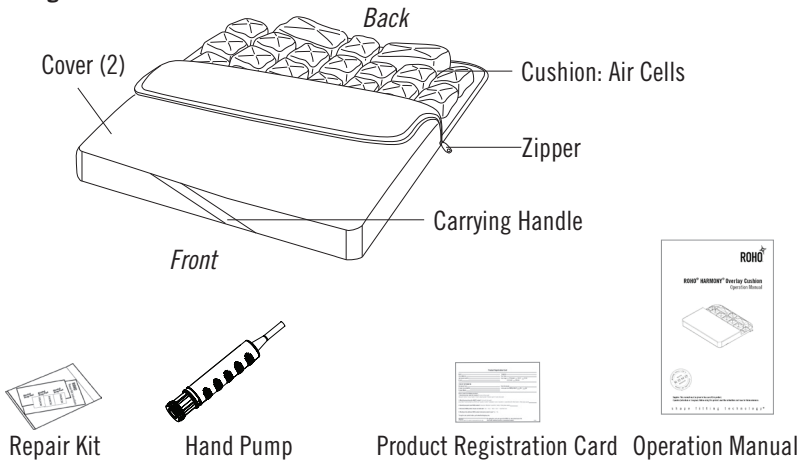

To order replacement parts, contact your product provider or ROHO, Inc., or visit therohostore.com.

Product Specifications

Materials: Cushion: PVC, made without DEHP; Inflation Valve: nickel-plated brass; Cover: Two-way stretch top, spacer fabric sides with a zipper, and a non-skid bottom with hook and loop fasteners to help secure the cushion in the chair. Refer to the care label attached to your cover for material content.

	Width (in.)	Depth (in.)	Width (cm)	Depth (cm)
HOV1415C	14½	15½	37.0	39.5
HOV1615C	16¼	15½	41.5	39.5
HOV1616C	16¼	16	41.5	40.5
HOV1815C	18¾	15½	47.5	39.5
HOV1816C	18¾	16½	47.5	42.0
HOV2017C	20½	16¾	52.0	42.5

Average Weight: 1¼ lbs. (0.6 kg); Height ranges from 1¼ in. (3 cm) to 2.0 in. (5 cm). Range is due to variation in air cell heights. Measurements based on HOV1815C. NOTE: All measurements are approximate and may vary depending on level of inflation.

Cushion Adjustment



Important Safety Information

- Check inflation frequently, at least once a day!
- **DO NOT** use an under-inflated cushion or an over-inflated cushion because the product benefits will be reduced or eliminated, resulting in an increased risk to skin and other soft tissue. If the cushion does not appear to be holding air, or if you are not able to inflate or deflate the cushion, see TROUBLESHOOTING. Immediately contact your clinical caregiver, distributor, or ROHO, Inc. if the problem persists.
- When possible, use the hook or loop fasteners to further secure the cushion to the seating surface.

1. Place the cushion in the wheelchair with the air cells facing up and the non-skid surface of the cover facing down. The individual should not sit on the cushion.
2. Slide the rubber nozzle of the hand pump over the inflation valve. Turn the nozzle to open the inflation valve, and inflate until all of the air cells feel firm.
3. Remove the hand pump.
4. Do not close the inflation valve.
5. Allow air to escape from the inflation valve. Listen (or place your hand in front of the inflation valve) to confirm that air is no longer coming out of the cushion. Close the inflation valve.

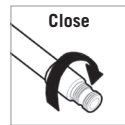
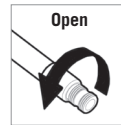

6. The individual should sit in the chair in their usual position. Confirm that the bony prominences are supported by the air cells.
7. Slide your hand between the air cells and the individual. Lift the leg slightly and feel for the lowest bony prominence, and then lower the leg to a sitting position. You should barely be able to move your fingertips.

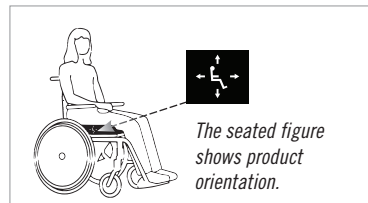

8. The recommended distance between the individual and the contoured foam base is ½" - 1". If the cushion has too much air or not enough air, open the valve, adjust as needed, and then close the valve.

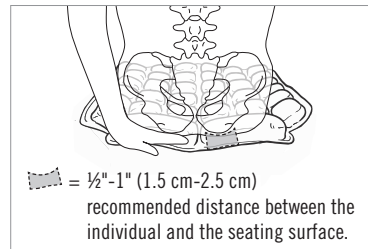

Cover Removal and Replacement



Inspect the cover for damage and replace if necessary.

Keeping a cover on your cushion will help to protect the cushion components. A cover will also help to keep the air cells together, which may aid in slide board transfers.

Cover Removal: Unzip the cover and remove it from the cushion.

Cover Replacement: Unzip the cover. With the air cells facing up, insert the cushion into the cover. Close the zipper. If hook fastener strips were removed prior to washing, replace the strips.

Troubleshooting

For additional assistance, contact your clinical caregiver, distributor, or ROHO, Inc.

Not Holding Air - Inspect for inflation valve and hose damage. Confirm that the inflation valve is completely closed. Look for holes in the cushion. If very small holes or no holes are visible, follow the instructions in the Repair Kit provided with your product. For inflation valve or hose damage, or for large holes or leaks in the cushion, see the ROHO Limited Warranty supplement provided with your product, or contact Customer Care.

Not Able To Inflate or Deflate Cushion - Confirm that the inflation valve is open. Inspect the inflation valve and hose for damage.

Uncomfortable / Unstable - Confirm that:

- the cushion is not over-inflated (See CUSHION ADJUSTMENT.)
- the air cells and the top of the cover are facing up.
- the cushion is centered beneath the individual.
- the cushion is properly sized to the individual and the wheelchair.

Allow the individual at least one hour to adjust to the cushion.

The Cushion Slides on the Wheelchair - Make sure the non-skid bottom of the cushion cover is facing down. Use directional labels on the cushion and on the cover to orient the cushion. Use hook and loop fasteners to further secure the cushion to the wheelchair.

Disposal: The components of the products in this manual are associated with no known environmental hazards when properly used and when disposed of in accordance with all local/regional regulations. Incineration must be performed by a qualified, licensed waste management facility.

Limited Warranty

Limited Warranty Term: 12 months from the date the product was originally purchased, with the exception of the cover, which has a 6-month limited warranty. The warranty does not apply to punctures, tears, burns, or misuse. See also the ROHO Limited Warranty supplement provided with your product, or contact Customer Care.

Cleaning and Disinfecting



Cleaning and disinfecting are separate processes. Cleaning must precede disinfection. Before use by a different individual: clean, disinfect, and check product for proper functioning.

Cover Care: Before cleaning and disinfecting, remove the cushion from the cover. Remove the hook fastener pieces from bottom of the cover.

To Clean the Cover: Machine wash in warm water (40°C) with mild detergent, gentle cycle, or wipe clean with neutral detergent and cold water. Tumble dry low.



To Disinfect the Cover: Hand wash in warm water (40°C) using 1 part household liquid bleach per 9 parts water. Keep the product wet with the bleach solution for 10 minutes and then rinse thoroughly. Or machine wash in hot water (60°C). Tumble dry low.



Follow the safety guidelines on the bleach container.



Cushion Care Cautions:

Valve(s) must be closed. DO NOT allow water or cleaning solution to enter the cushion. DO NOT machine wash or machine dry the cushion. Use of the following may cause damage to the cushion: abrasives (steel wool, scouring pads); caustic, automatic dishwasher detergents; cleaning products that contain petroleum or organic solvents, including acetone, toluene, Methyl Ethyl Ketone (MEK), naphtha, dry cleaning fluid, adhesive remover; oil-based lotions, lanolin, or phenolic-based disinfectants; ozone gas; ultraviolet light cleaning methods.

To Clean the Cushion: Close the inflation valve. Hand wash, using mild liquid hand soap, hand dishwashing liquid, laundry detergent, or a multipurpose detergent (Follow product label instructions.) Gently scrub all cushion surfaces, using a soft plastic bristle brush, a sponge or a cloth. Rinse with clean water. Air dry.

To Disinfect the Cushion: Repeat cleaning instructions, using 1 part household liquid bleach per 9 parts water. Keep the product wet with the bleach solution for 10 minutes. Rinse thoroughly with clean water. Air dry.



Follow the safety guidelines on the bleach container.

Note: Most germicidal disinfectants are safe if used following the disinfectant manufacturer's dilution directions.



Note About Sterilization:

High temperatures accelerate aging and will damage the product assembly.

ROHO products are not packaged in a sterile condition, nor are they intended or required to be sterilized prior to use. If institution protocol demands sterilization: First, follow the cleaning and disinfecting instructions; then, open the inflation valve and use the lowest possible sterilizing temperature, but not to exceed 60°C (158°F), for the shortest time possible. DO NOT autoclave.



Mailing / Shipping Address:
1501 South 74th Street, Belleville, IL 62223-5900 USA

Administrative Offices:
100 N. Florida Avenue, Belleville, IL 62221-5429 USA
U.S.: 800-851-3449 • Fax 888-551-3449
Outside the U.S.: 618-277-9150 • Fax 618-277-6518

ROHO.com



The Quality Management System
of ROHO, Inc. is certified to
ISO 9001:2008 and ISO 13485:2003.