



ROHO® AirLITE® Cushion

Operation Manual



SUPPLIER: This manual must be given to the user of this product.

CAREGIVER: Before using this product, read the instructions and save for future reference.

shape fitting technology®

Table of Contents

Intended Use	2
Important Safety Information	
Product Specifications	3
Cushion and Cover Placement	4
Care Instructions	5
Troubleshooting	
Return Policy	6
Contact Information	
Disposal	7
Limited Warranty	
Español	8
Français	15
Deutsch	22
Italiano	29
Nederlands	36
Dansk	43
Svenska	50
Norsk	57
Suomi	64
Português	71

ROHO, Inc.
100 N. Florida Avenue, Belleville, IL 62221-5429 U.S.A.
U.S.A.: 800-851-3449, Fax 888-551-3449
Outside the U.S.A.: 618-277-9150, Fax 618-277-6518
permobilus.com • cc@roho.com

© 2014, 2017 ROHO, Inc.

Products in this manual may be covered by one or more U.S. and foreign patents and trademarks. The following are trademarks and registered trademarks of ROHO, Inc.: AirLITE®, ROHO®, and shape fitting technology®.

ROHO, Inc. has a policy of continual product improvement and reserves the right to amend specifications presented in this manual.

Intended Use

The ROHO® AirLITE® Cushion (AirLITE) is a wheelchair support surface with a non-adjustable, air-filled, segmented-design ROHO AIR FLOTATION insert encased in contoured foam. The AirLITE is intended to conform to an individual's seated shape to provide positioning. There is a weight limit of 300 lbs. (136 kg), and the cushion must be properly sized to the individual. The AirLITE must be used with the supplied cover.

ROHO, Inc. recommends evaluation by a clinician who is experienced in seating, positioning and mobility: 1) to determine whether the cushion is appropriate for the individual; and 2) to determine whether a solid seat platform is recommended if using the cushion on a sling-seat wheelchair.

ROHO medical products are intended to be part of an overall care regimen. ROHO, Inc. recommends that a clinician make product recommendations based upon an evaluation of the individual's medical and therapeutic needs and overall condition.



Important Safety Information

Warnings

- **DO NOT** use if the individual has an existing pressure ulcer. Skin/soft tissue breakdown can occur due to a number of factors, which vary by individual. Check skin frequently, at least once a day. Redness, bruising, or darker areas (when compared to normal skin) may indicate the beginning of soft tissue breakdown. Consult with a clinician immediately.
- The cushioning device and the cover **MUST** be compatible sizes and **MUST** be used as directed in this manual. **IF THEY ARE NOT**, the benefits provided by the cushion may be reduced or eliminated, increasing the risk to skin or other soft tissue and increasing the risk of falling.
- **DO NOT** use this cushion as a water flotation device (e.g. a Life Preserver). It will **NOT** support you in water.

Cautions:

- **DO NOT** expose cushion to high heat, open flames, or hot ashes.
- Prolonged exposure to ozone will degrade materials used in the AirLITE cushion and may affect the performance of your product and invalidate the product warranty.

Product Specifications

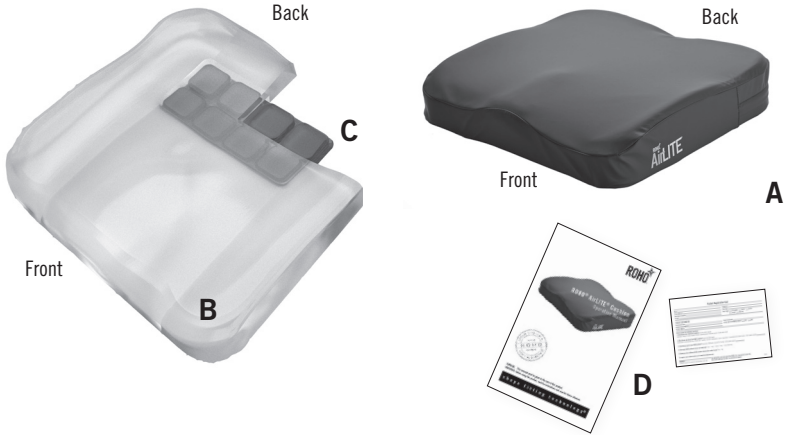

- A. Cover:** fluid-resistant, two-way stretch top, two-way stretch sides, and non-skid bottom
- B. Base:** polyurethane and polyethylene
- C. Air insert:** polyurethane, non-adjustable, segmented
- D. Operation manual and product registration card**

Sizing (all measurements are approximate):

	Smallest Width	Smallest Depth	Largest Width	Largest Depth
in.	13.0	13.0	20.0	20.0
cm	33.0	33.0	51.0	51.0

Average Weight: 2 lbs. (0.9 kg)
 Height ranges from 2 in. (5 cm) to 3¾ in. (9.5 cm)

Cushion and Cover Placement

Note: Refer to the label on the bottom of the cushion and to the image on the cover to correctly orient your cushion and cover.

Cushion Placement:

1. Place the cushion directly on the seat.

Note: If a seat insert is used, place it inside the cover, beneath the foam base.



When possible, use the hook or loop fasteners to further secure the cover to the seating surface.

2. Have the individual sit on the cushion, making sure the bony prominences are supported by the air cells.

Check to make sure that the cushion is properly sized to the individual and the wheelchair.

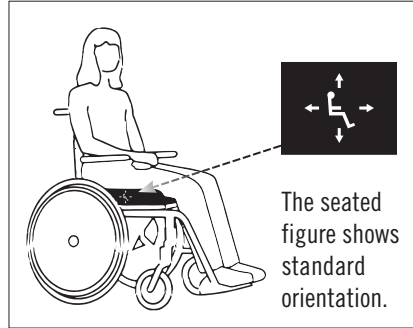

Cover Removal: Unzip the cover.
Remove the cover from the cushion.

Cover Placement:

1. Unzip the cover.
2. Insert the cushion into the cover, front edge first, with the contoured foam facing up.
3. Close the zipper.

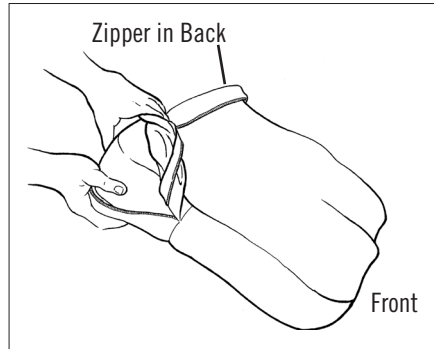

Inspect the cover for damage and replace if necessary.

Care Instructions

Cleaning and disinfecting are separate processes. Cleaning must precede disinfection. Before use by a different individual: clean, disinfect, and check product for proper functioning.

DO NOT:

- machine wash or dry the cushion
- immerse the cushion in water.
- autoclave, steam clean, or expose cushion to temperatures in excess of 150°F (65°C)
- use caustic, automatic dishwasher detergents
- use cleaning products containing petroleum or organic solvents such as acetone, toluene, Methyl Ethyl Ketone (MEK), naphtha, dry cleaning fluids, or adhesive removers
- expose the cushion to ozone gas or to ultraviolet light cleaning methods

NOTE: Before cleaning and disinfecting, remove the cover from the cushion. Remove hook fastener pieces from the bottom of the cover.

To Clean the Cover: Machine wash in cold water (30°C) with mild detergent, gentle cycle. Tumble dry low.



To Disinfect the Cover: Machine wash in hot water (60°C). Tumble dry low.



To Clean the Cushion: Remove the cover. Wipe gently with a cloth dampened with water and a household detergent. Rinse cloth and re-wipe. Allow foam to air dry thoroughly before putting the cover on.



 **Disinfectants are not effective on porous surfaces such as foam. If the cushion becomes soiled or contaminated, DO NOT use with multiple individuals.**



This symbol means, “Wipe with a damp cloth.”

Troubleshooting	
The cushion feels uncomfortable or unstable.	<ul style="list-style-type: none"> - Confirm AirLITE size and orientation. - Confirm that there are no obstructions between AirLITE and the seating surface. - Consult with a clinician.
The cushion slides on the chair.	<ul style="list-style-type: none"> - Make sure the cover's non-skid bottom faces the seating surface. - If a seat insert is used, make sure it is inside the cover, beneath the foam base. - When possible, use the hook or loop fasteners to further secure the cover to the seating surface.
The cushion exhibits unusual stiffness; the cushion has been in temperatures lower than 32°F (0°C)	Before use, allow the cushion to warm to room temperature 72°F (22°C).

Return Policy

Contact ROHO before returning your product. Returned products require prior authorization from ROHO, Inc., must be new and unused, and are subject to a restocking charge.

Contact Information

U.S.A.: Phone: 800-851-3449 • Fax: 888-551-3449

Warranty Service: warranty@roho.com • Customer Care: cc@roho.com

Note: If directed to return any items, please send to:
ROHO, Inc., 1501 South 74th Street, Belleville, IL 62223

Outside the U.S.A.: intl@roho.com • Phone: 618-277-9150 • Fax: 618-277-6518
Or visit permobilus.com for a list of ROHO International distributors.

Disposal

When properly used and disposed of, the components of the products in this manual are associated with no known environmental hazards. Dispose of the product and/or components in accordance with the applicable regulations in your jurisdiction. **DO NOT INCINERATE.**

Limited Warranty

What is covered? ROHO, Inc. covers any defects in materials or workmanship of the product.

For how long? 24 months from the date the product was originally purchased. The warranty does not apply to punctures, tears or burns, nor does it apply to the removable cover.

What is not covered? A product that has been misused, damaged by an accident, or damaged from “an act of Nature”, e.g., flood, tornado, earthquake, fire. Any substitutions of supplied product accessories or modification to the product will void the warranty.

What the customer must do: Within the U.S.A., the customer must contact the ROHO, Inc. Warranty Service Department. Note: Any items sent to ROHO, Inc. without prior authorization will not be returned to the customer. Outside the U.S.A., contact your country's ROHO distributor.

Questions? See CONTACT INFORMATION.

Disclaimer: Any implied warranties, including the MERCHANTABILITY AND FITNESS FOR A PARTICULAR PURPOSE are limited to the same time period of the product types referenced above in the “For how long?” section and any action for a breach of such warranties or any express warranties herein must be commenced within that time. ROHO, Inc. shall not be responsible for any incidental or consequential damages with respect to economic loss to property, whether as a result of a breach of express or implied warranties or otherwise.

Your Rights and the Effect of This Warranty Upon Them: This warranty restricts the duration of all implied warranties as noted above and limits or excludes recovery for incidental or consequential damages. Some jurisdictions do not allow limitations on how long implied warranties will last and some jurisdictions do not allow the exclusion or limitation of consequential or incidental damages, so those provisions may not apply to you. While this warranty gives you specific legal rights, you may also have other rights which vary from jurisdiction to jurisdiction.



Mailing/Shipping Address:
1501 South 74th Street, Belleville, IL 62223-5900 USA

Administrative Offices:
100 N. Florida Avenue, Belleville, IL 62221-5429 USA
U.S.: 800-851-3449 • Fax 888-551-3449
Outside the U.S.: 618-277-9150 • Fax 618-277-6518

permobilus.com



The Quality Management System of
ROHO, Inc. is certified to
ISO 9001:2008 and ISO 13485:2003.

Item #T22301
Rev. Date: 4/13/17
Print Date:

Qty:



MDSS GmbH
Schiffgraben 41
30175 Hannover, Germany

